

LEGEND

- Extended Great Southern Rail Trail
- Extended Great Southern Rail Trail Interim Route
- Extended Great Southern Rail Trail Ultimate Route
- Existing Trees

NOT FOR CONSTRUCTION

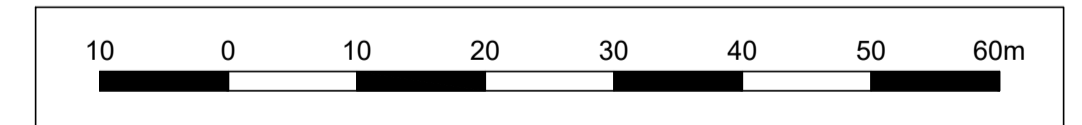

© COPYRIGHT All rights reserved. Beveridge Williams & Co Pty Ltd has granted a license to the recipient to use this document for its intended purpose. No unauthorized copying is permitted.	
Rev	Description
B	Amendment for Submission 24.07.19 J.L. G.C.
A	Initial Issue 07.05.19 O.H. G.C.

Project Name	LEONGATHA RAIL PRECINCT STRUCTURE
Drawing Title	CONTEXT PLAN
Client	SOUTH GIPPSLAND SHIRE COUNCIL

Designed	O.HU
Drawn	J.LI
Approved	G.CATER
Date	24.07.2019

BW Beveridge Williams
 development & environment consultants
 1 Glenferrie Road
 Malvern, Victoria 3144
 ph : 03 9524 8888
 www.beveridgewilliams.com.au

Scale	1:500 @ A1
Project Ref.	1800445
Drawing No.	L001
Rev.	B

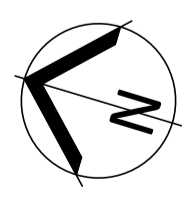

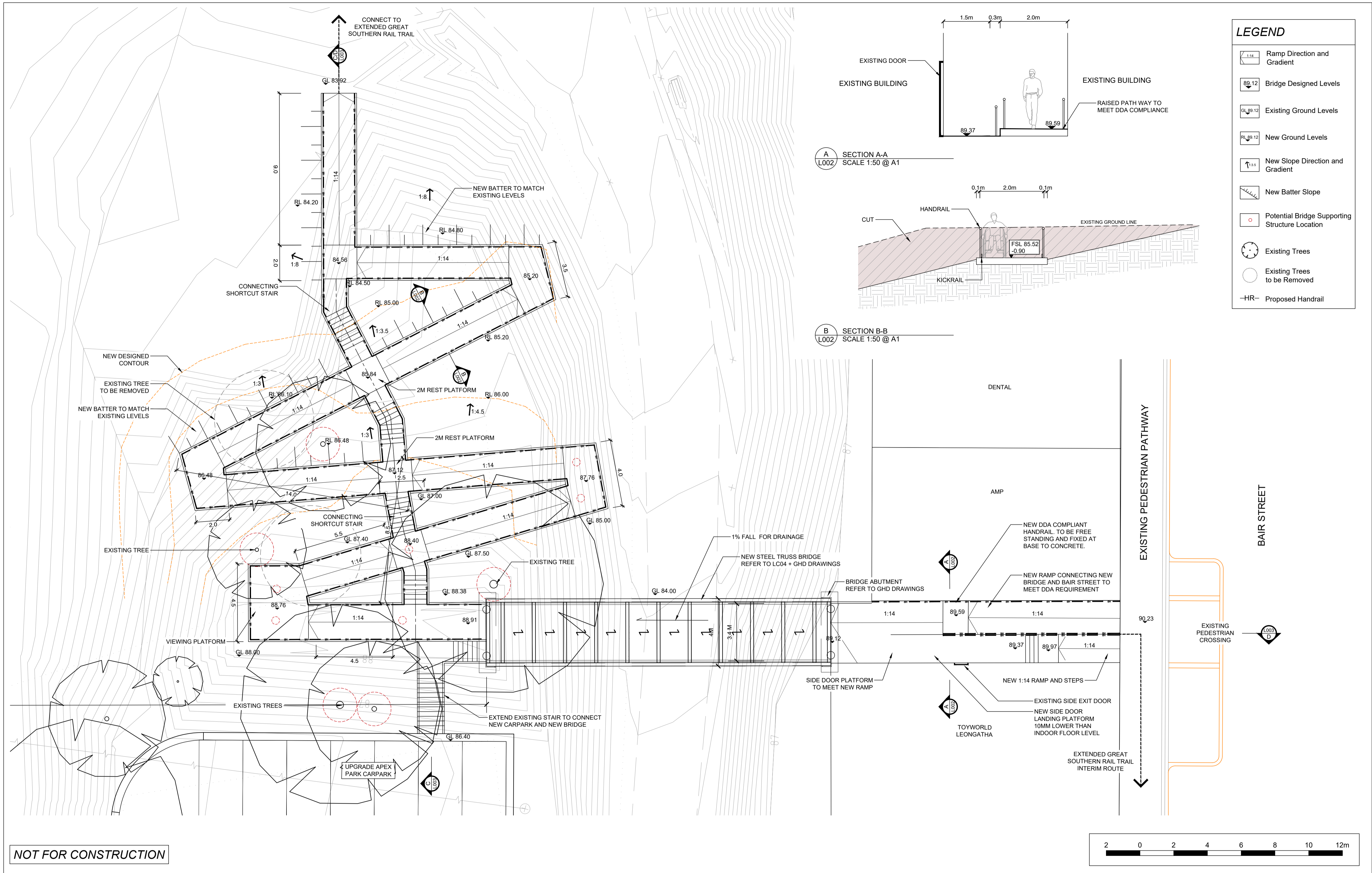

© COPYRIGHT All rights reserved. Beveridge Williams & Co Pty Ltd has granted a license to the recipient to use this document for its intended purpose. No unauthorized copying is permitted.	
B	Amendment for Submission 24.07.19 J.L. G.C.
A	Initial Issue 07.05.19 O.H. G.C.
Rev	Description Date By App. Rev Description Date By App.

Project Name	LEONGATHA RAIL PRECINCT STRUCTURE
Drawing Title	GENERAL ARRANGEMENT PLAN
Client	SOUTH GIPPSLAND SHIRE COUNCIL

Designed	O.HU
Drawn	J.LI
Approved	G.CATER
Date	24.07.2019

Scale: 1:100 @ A1

Project Ref: 1800445 Drawing No. L002 Rev. B

Drawing Ref: \\MELFRED\DEV\DATA\085 DATA\1800445 - LEONGATHA RAIL PRECINCT STRUCTURES_LANDSCAPE\1800445_LEONGATHA LANDSCAPE PLAN CURRENT.DWG

Beveridge Williams
development & environment consultants

1 Glenferrie Road
Malvern, Victoria 3144
ph : 03 9524 8888
www.beveridgewilliams.com.au

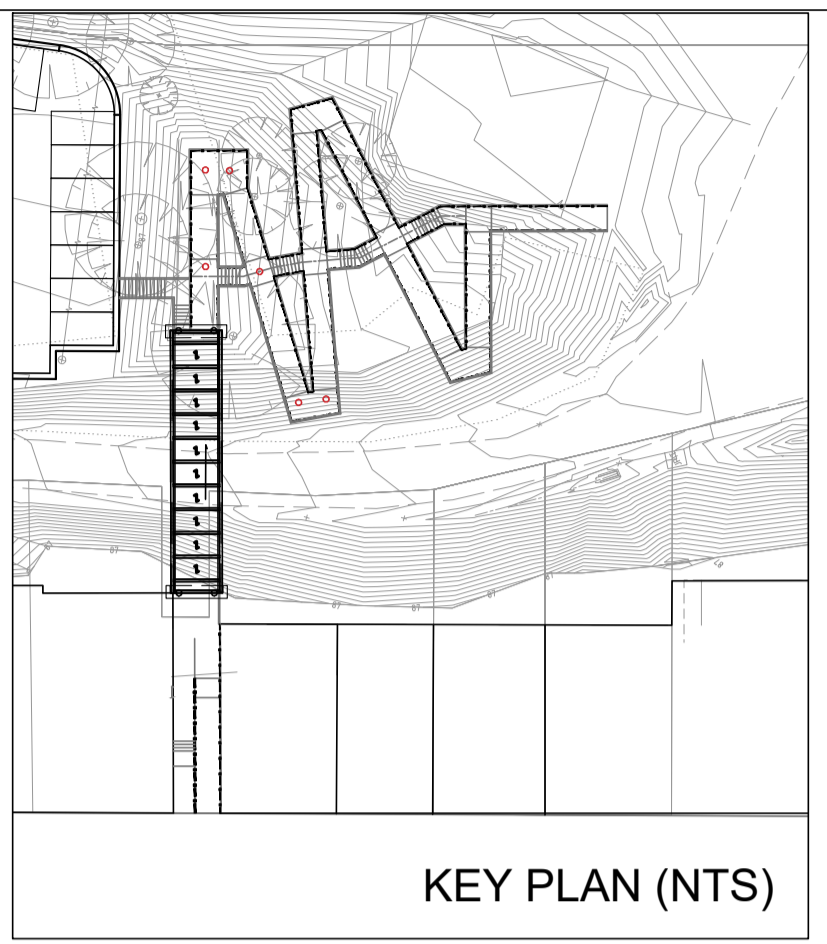
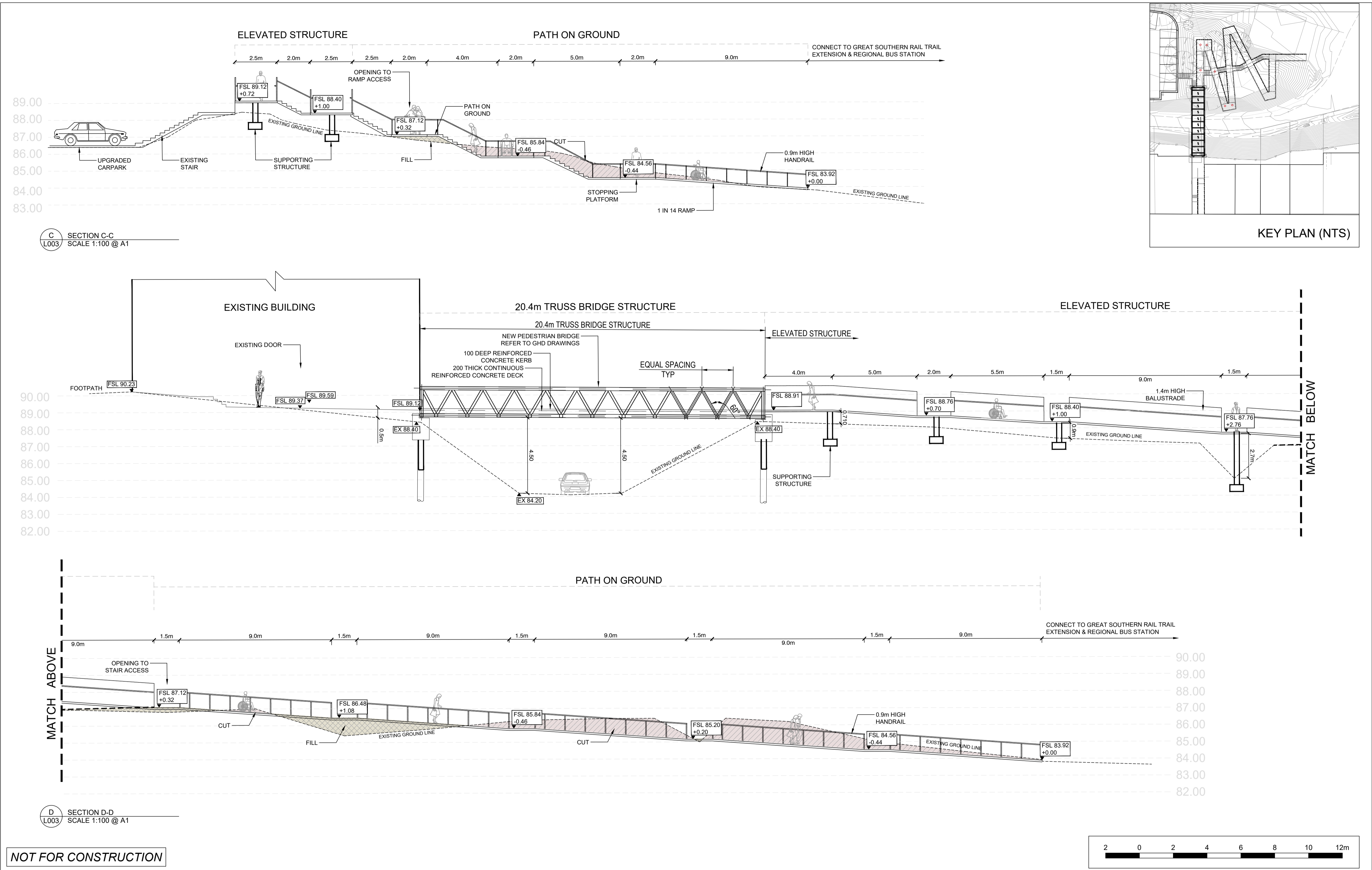

<p>© COPYRIGHT All rights reserved. Beveridge Williams & Co Pty Ltd has granted a license to the recipient to use this document for its intended purpose. No unauthorized copying is permitted.</p>		<p>Project Name LEONGATHA RAIL PRECINCT STRUCTURE</p>		<p>Designed O.HU</p>		<p>Beveridge Williams development & environment consultants 1 Glenferrie Road Malvern, Victoria 3144 ph : 03 9524 8888 www.beveridgewilliams.com.au</p>	<p>Scale 1:100 @ A1</p>		
<p>Drawing Title SECTIONS</p>		<p>Client SOUTH GIPPSLAND SHIRE COUNCIL</p>		<p>Drawn J.LI</p>			<p>Project Ref. 1701641-00 Drawing No. L003 Rev. B</p>		
<p>Rev Description Date By App. Rev Description Date By App.</p>		<p>Client SOUTH GIPPSLAND SHIRE COUNCIL</p>		<p>Approved G.CATER</p>		<p>Drawing Ref. \\MELFRED\ITV\DATA\OBS DATA\1800445 - LEONGATHA RAIL PRECINCT STRUCTURES_LANDSCAPE\1800445 - LEONGATHA LANDSCAPE PLAN CURRENT.DWG</p>		<p>Initial Issue 07.05.19 O.H. G.C.</p>	
<p>Bridge Amended 24.07.19 J.L. G.C.</p>		<p>Client SOUTH GIPPSLAND SHIRE COUNCIL</p>		<p>Date 24.07.2019</p>		<p>Scale 1:100 @ A1</p>		<p>Project Ref. 1701641-00 Drawing No. L003 Rev. B</p>	

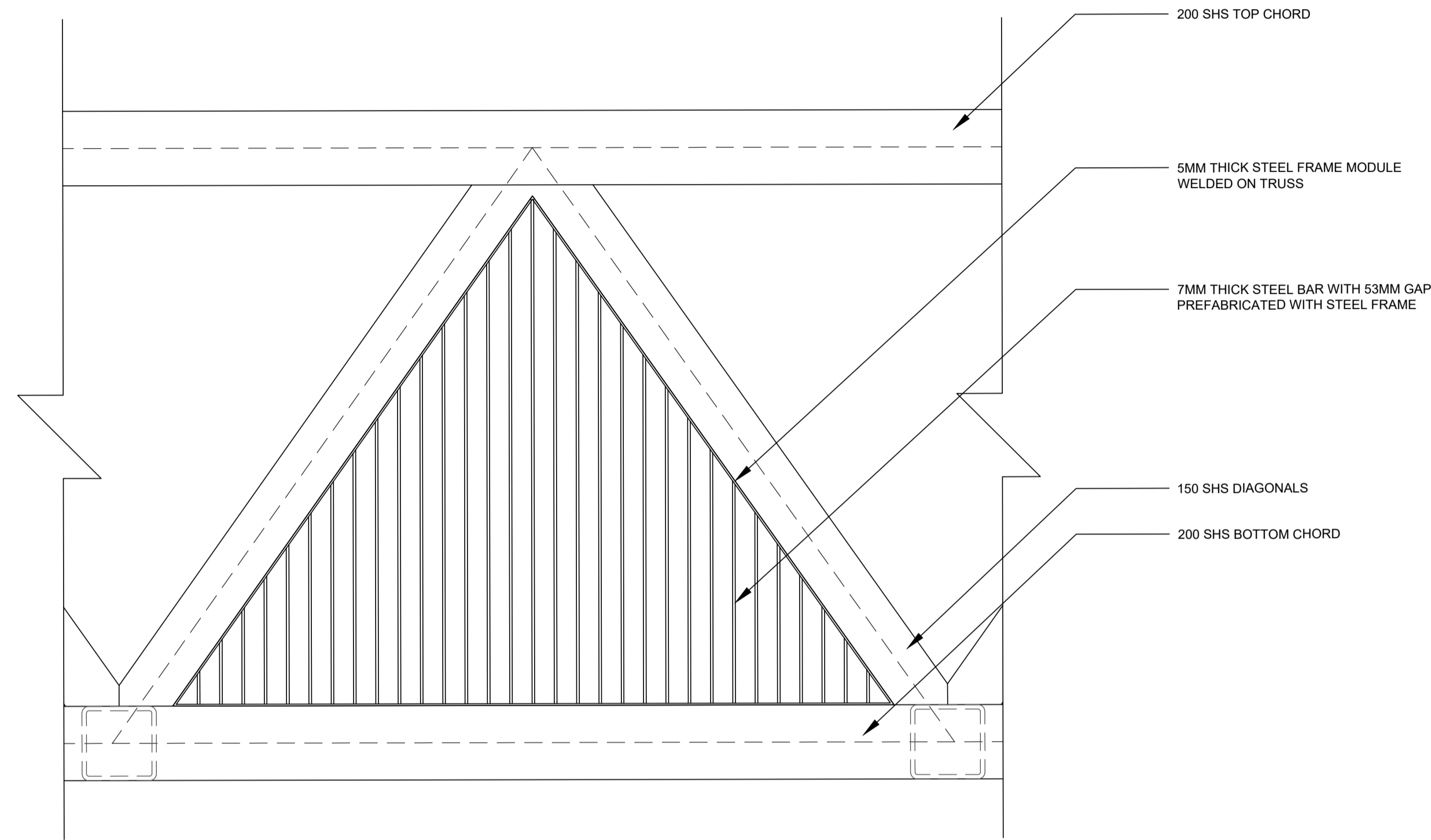

A
L004 BALUSTRADE MODULE DETAIL
SCALE 1:20 @ A1

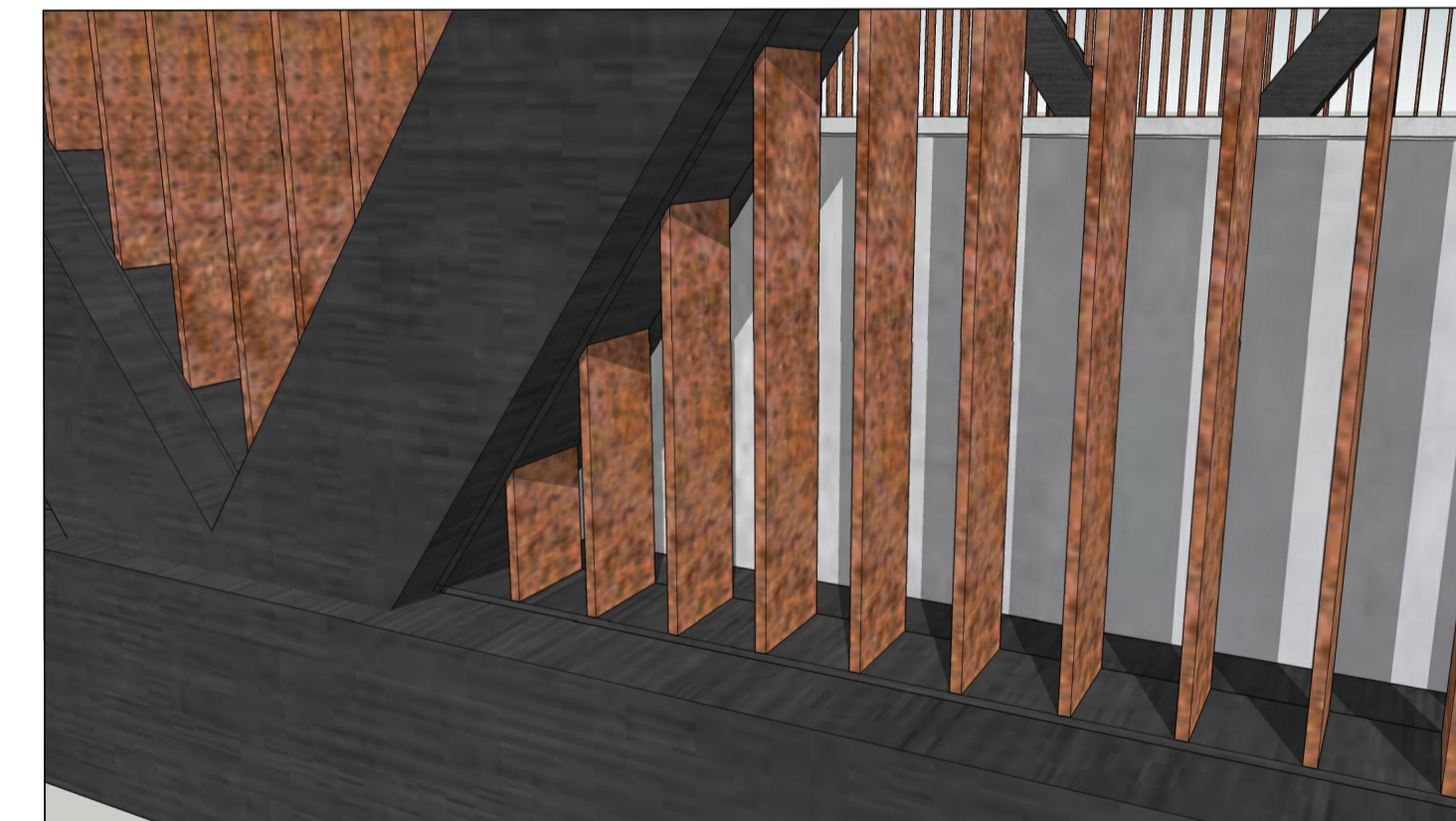
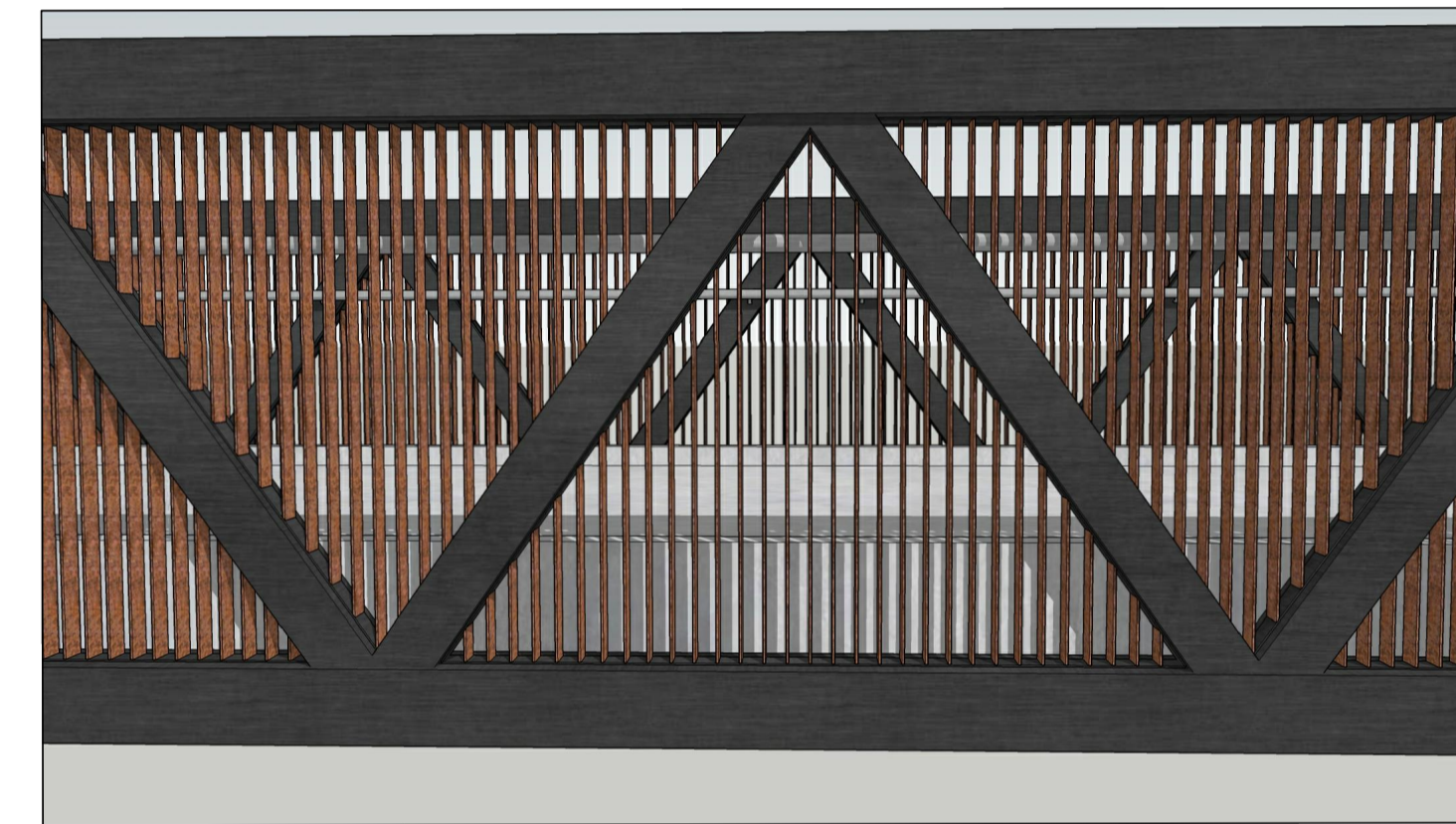

B
L004 BALUSTRADE MODEL IMAGES
SCALE NTS

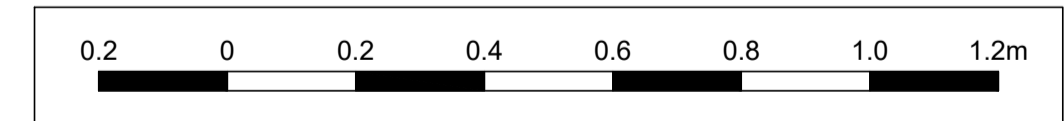

NOT FOR CONSTRUCTION

<p>© COPYRIGHT All rights reserved. Beveridge Williams & Co Pty Ltd has granted a license to the recipient to use this document for its intended purpose. No unauthorized copying is permitted.</p>		<p>Project Name LEONGATHA RAIL PRECINCT STRUCTURE</p>	<p>Designed O.HU</p>	 <p>Beveridge Williams development & environment consultants 1 Glenferrie Road Malvern, Victoria 3144 ph : 03 9524 8888 www.beveridgewilliams.com.au</p>	<p>Scale 1:10 @ A1</p>
<p>Drawing Title TRUSS BRIDGE DETAILS</p>		<p>Client SOUTH GIPPSLAND SHIRE COUNCIL</p>	<p>Drawn J.LI</p>		<p>Project Ref. 1800445</p>
<p>Rev Description Date By App.</p>			<p>Approved G.CATER</p>		<p>Rev.</p>
<p>B Amendment for Submission 24.07.19 J.L. G.C.</p>			<p>Date 24.07.2019</p>		<p>Drawing Ref. \\MELFLE01V\DATA\JOBS DATA\1800445 - LEONGATHA RAIL PRECINCT STRUCTURES_LANDSCAPE\1800445_LEONGATHA LANDSCAPE PLAN CURRENT.DWG</p>
<p>A Initial Issue 07.05.19 O.H. G.C.</p>					

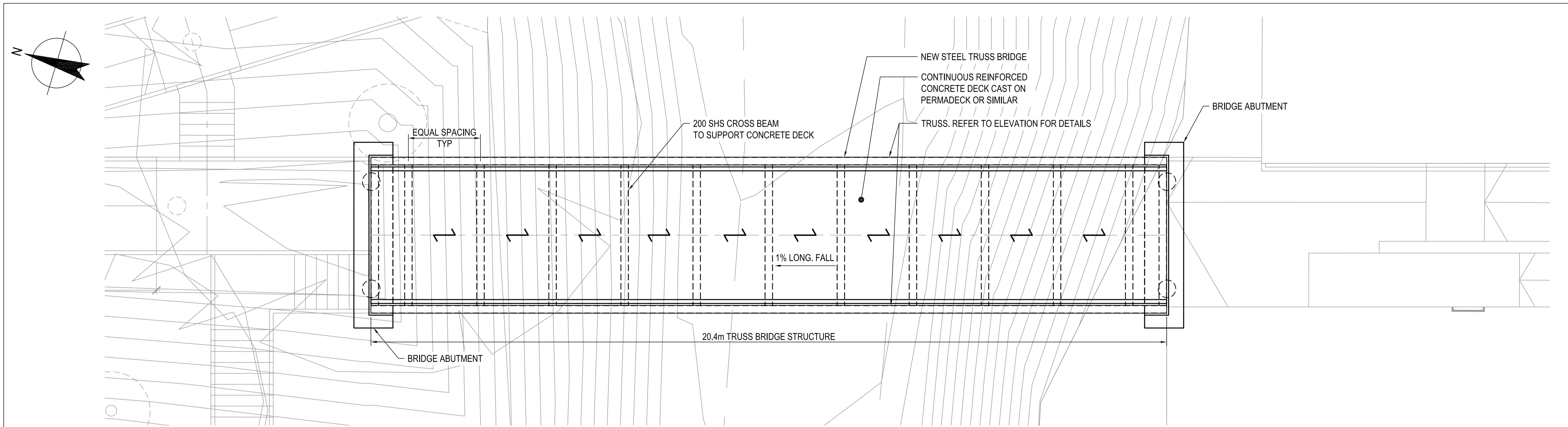

TRUSS BRIDGE GENERAL ARRANGEMENT
SCALE 1:50

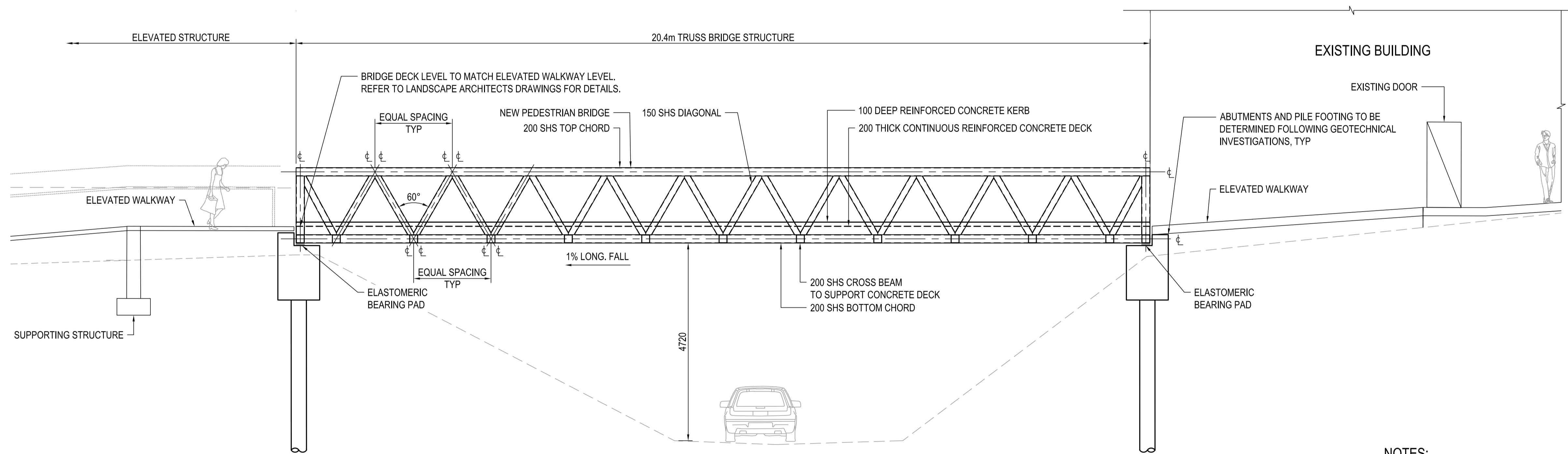

TRUSS BRIDGE ELEVATION
SCALE 1:50

BALUSTRADE INFILL NOT SHOWN FOR CLARITY

- NOTES:**
- REFER TO BEVERIDGE WILLIAMS (LANDSCAPE ARCHITECT) DRAWINGS FOR SETOUT AND LEVELS.
 - BRIDGE DESIGN AND SPECIFICATIONS TO BE IN ACCORDANCE WITH AS5100.

PRELIMINARY

<p>0 500 1000 1500 2000 2500mm SCALE 1:50 AT ORIGINAL SIZE</p>		<p>Level 8, 180 Lonsdale Street, Melbourne VIC 3000 Australia T 61 3 8687 5000 F 61 3 8687 8111 E mel@mail@ghd.com.au W www.ghd.com</p>		<p>DO NOT SCALE</p> <p>Conditions of Use: This document may only be used by GHD's client (and any other person who GHD has agreed can use this document) for the purpose for which it was prepared and must not be used by any other person or for any other purpose.</p>	<p>Drawn H. ALMADIN Drafting Check B. SACAYANAN Approved (Project Director) - Date - Scale AS SHOWN</p>	<p>Designer P. BARRETT Design Check -</p>	<p>Client BEVERIDGE WILLIAMS & CO PTY LTD Project LEONGATHA RAIL PRECINCT Title PEDESTRIAN BRIDGE GENERAL ARRANGEMENT AND ELEVATION</p>	<p>Original Size A1 Drawing No: 31-36060-S001 Rev: B</p>
<p>B INCLUDE LONGITUDINAL FALL</p>	<p>EP PB GL 26.07.19</p>	<p>A CONCEPT DESIGN</p>	<p>HPA PB GL 30.04.19</p>	<p>No Revision Note: * Indicates signatures on original issue of drawing or last revision of drawing</p>	<p>Drawn Job Manager Project Director Date</p>	<p>Plot Date: 26 July 2019 - 4:57 PM Plotted by: Edward Pearce Cad File No: G:\3136060\CADD\Drawings\31-36060-S001.dwg</p>		