

Attachment 2 Outline Development Plan - Road Reserve Infrastructure Plan

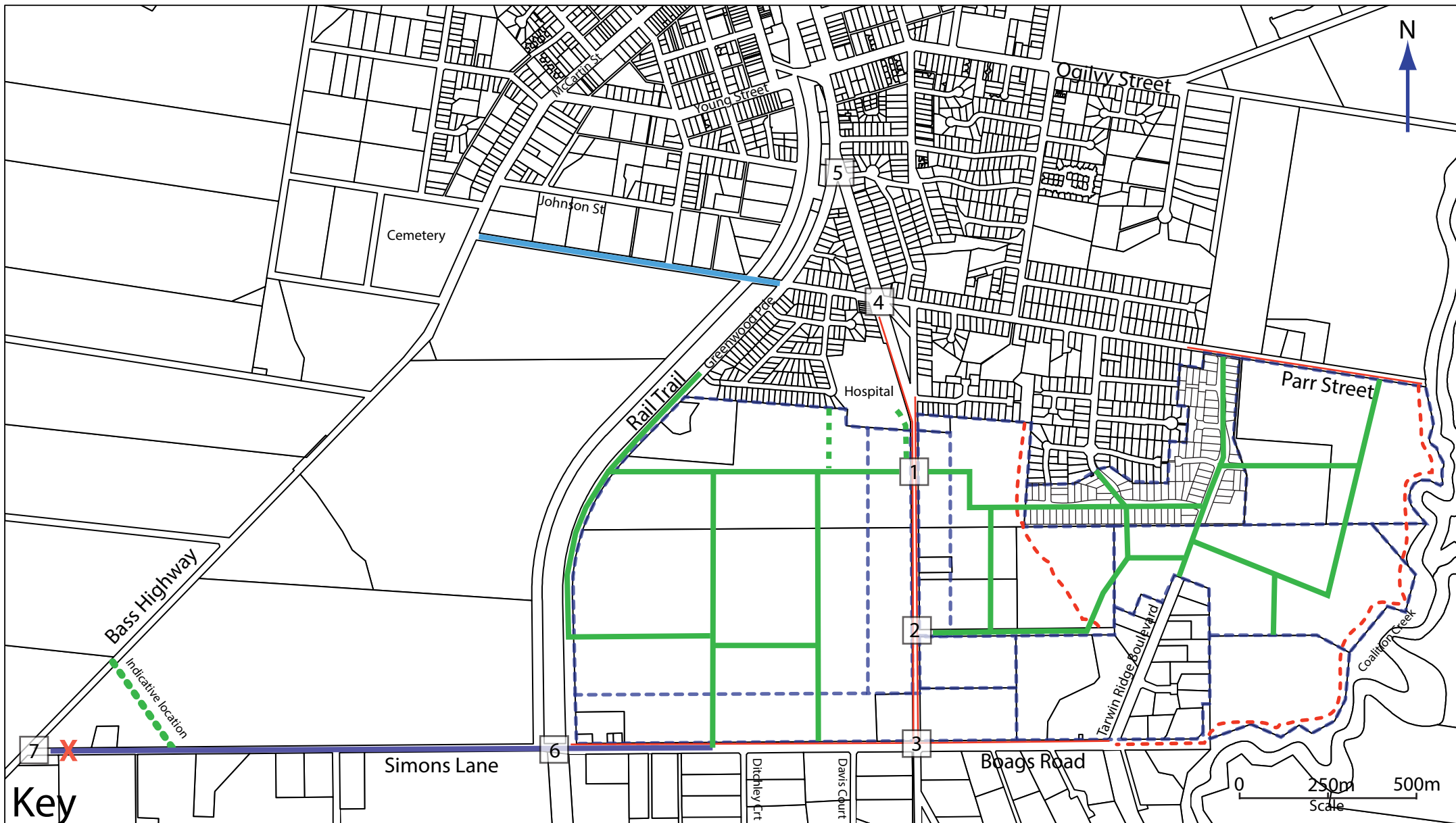

Key

- Internal roads. Note: Locations are indicative and establish general connectivity principles. All new roads to have footpaths in accordance with Infrastructure Design Manual.
- - - Footpaths required for existing roads.
- - - Pedestrian connectivity (indicative).
- - - Hospital access options (indicative).
- Simons Lane Upgrade required for full development scenario.
- - - Parr Street extension (long term option).
- No. Critical Intersection. See ODP Section 5.
- - - Land Use Areas. See Attachment 1.
- - - Simons Lane intersection realignment option.
- X Road closure point.

